

End Mill Holders - Inch Balanced G6.3

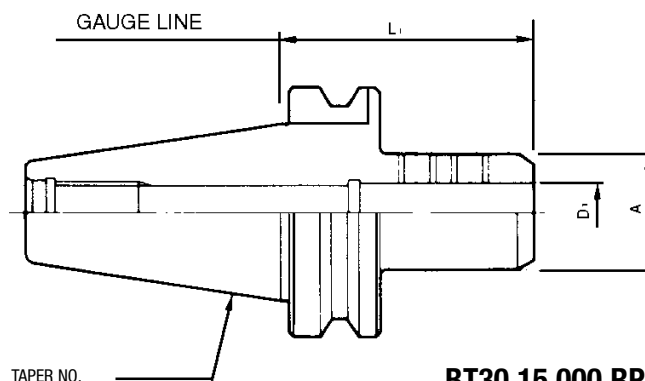

**BT30 15,000 RPM
BT40 15,000 RPM**

BT Flange Tools

Taper	Order No.	Device Type	D ₁ (in)	L ₁ (in)	A (in)
30	477-400	BT30-SL 1/8-60	0.125	2.36	0.75
30	477-401	BT30-SL 1/8-105	0.125	4.13	0.75
30	477-405	BT30-SL 3/16-60	0.1875	2.36	0.75
30	477-406	BT30-SL 3/16-105	0.1875	4.13	0.75
30	477-410	BT30-SL 1/4-60	0.250	2.36	0.81
30	477-411	BT30-SL 1/4-105	0.250	4.13	0.81
30	477-415	BT30-SL 5/16-60	0.3125	2.36	1.00
30	477-416**	BT30-SL 5/16-105	0.3125	4.13	1.00
30	477-420	BT30-SL 3/8-60	0.375	2.36	1.00
30	477-421	BT30-SL 3/8-105	0.375	4.13	1.00
30	477-425	BT30-SL 1/2-60	0.500	2.36	1.25
30	477-426	BT30-SL 1/2-105	0.500	4.13	1.25
30	477-430	BT30-SL 5/8-60	0.625	2.36	1.50
30	477-431* **	BT30-SL 5/8-105	0.625	4.13	1.50
30	477-435	BT30-SL 3/4-60	0.750	2.36	1.75
30	477-436* **	BT30-SL 3/4-105	0.750	4.13	1.75
40	477-100	BT40-SL 1/8-65	0.125	2.55	0.75
40	477-101	BT40-SL 1/8-101.6	0.125	4.00	0.75
40	477-105	BT40-SL 3/16-65	0.1875	2.55	0.75
40	477-106	BT40-SL 3/16-101.6	0.1875	4.00	0.75
40	477-110	BT40-SL 1/4-65	0.250	2.55	0.81
40	477-111	BT40-SL 1/4-101.6	0.250	4.00	0.81
40	477-115	BT40-SL 5/16-65	0.3125	2.55	1.00
40	477-116	BT40-SL 5/16-101.6	0.3125	4.00	1.00
40	477-120	BT40-SL 3/8-65	0.375	2.55	1.00
40	477-121	BT40-SL 3/8-101.6	0.375	4.00	1.00
40	477-123	BT40-SL 7/16-65	0.4375	2.55	1.15
40	477-125-S	BT40-SL 1/2-44.45	0.500	1.75	1.25
40	477-125	BT40-SL 1/2-65	0.500	2.55	1.25
40	477-126	BT40-SL 1/2-101.6	0.500	4.00	1.25
40	477-130-S	BT40-SL 5/8-44.45	0.625	1.75	1.50
40	477-130	BT40-SL 5/8-65	0.625	2.55	1.50

Taper	Order No.	Device Type	D ₁ (in)	L ₁ (in)	A (in)
40	477-131	BT40-SL 5/8-101.6	0.625	4.00	1.50
40	477-135-S	BT40-SL 3/4-44.45	0.750	1.75	1.75
40	477-135	BT40-SL 3/4-65	0.750	2.55	1.75
40	477-140**	BT40-SL 7/8-85	0.875	3.35	2.00
40	477-141	BT40-SL 7/8-101.6	0.875	4.00	2.00
40	477-145-S	BT40-SL 1-44.45	1.000	1.75	2.25
40	477-145	BT40-SL 1-95	1.000	3.74	2.25
40	477-150-S	BT40-SL 1-1/4-50.8	1.250	2.00	2.50
40	477-150	BT40-SL 1-1/4-85	1.250	3.35	2.50
40	477-151	BT40-SL 1-1/4-127	1.250	5.00	2.50
40	477-155	BT40-SL 1-1/2-110	1.500	4.33	2.75
45	477-220*	BT45-SL 3/8-75	0.375	2.95	1.00
50	477-310*	BT50-SL 1/4-75	0.250	2.95	0.81
50	477-320* **	BT50-SL 3/8-75	0.375	2.95	1.00
50	477-321* **	BT50-SL 3/8-152.4	0.375	6.00	1.00
50	477-325*	BT50-SL 1/2-75	0.500	2.95	1.25
50	477-326*	BT50-SL 1/2-152.4	0.500	6.00	1.25
50	477-330* **	BT50-SL 5/8-75	0.625	2.95	1.50
50	477-331*	BT50-SL 5/8-152.4	0.625	6.00	1.50
50	477-335*	BT50-SL 3/4-75	0.750	2.95	1.75
50	477-340* **	BT50-SL 7/8-90	0.875	3.54	2.00
50	477-345*	BT50-SL 1-105	1.000	4.13	2.25
50	477-346*	BT50-SL 1-152.4	1.000	6.00	2.25
50	477-350*	BT50-SL 1-1/4-105	1.250	4.13	2.50
50	477-351*	BT50-SL 1-1/4-152.4	1.250	6.00	2.50
50	477-355*	BT50-SL 1-1/2-105	1.500	4.13	2.75
50	477-356* **	BT50-SL 1-1/2-152.4	1.500	6.00	2.75
50	477-360* **	BT50-SL 2-135	2.000	5.31	3.75
50	477-361* **	BT50-SL 2-152.4	2.000	6.00	3.75

* While stock is still available. ** Not Balanced.

End Mill Holders - Inch High Balanced - G2.5



BT Flange Tools

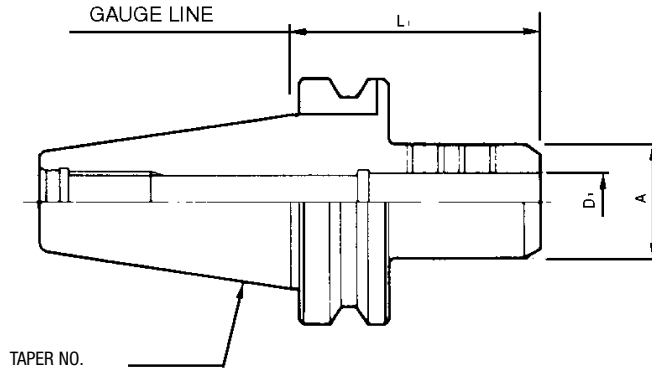

BT

Taper	Order No.	Device Type	D ₁ (in)	L ₁ (in)	A (in)	Max RPM
40	477-200-B*	BT40B-SL 1/8 - 65	0.125	2.55	0.75	20,000
40	477-205-B*	BT40B-SL 3/16 - 65	0.1875	2.55	0.75	20,000
40	477-206-B*	BT40B-SL 3/16 - 101.6	0.1875	4.00	0.75	15,000
40	477-211-B*	BT40B-SL 1/4 - 101.6	0.250	4.00	0.81	15,000
40	477-215-B*	BT40B-SL 5/16 - 65	0.3125	2.55	1.00	20,000
40	477-216-B*	BT40B-SL 5/16 - 101.6	0.3125	4.00	1.00	15,000
40	477-220-B*	BT40B-SL 3/8 - 65	0.375	2.55	1.00	20,000
40	477-221-B*	BT40B-SL 3/8 - 101.6	0.375	4.00	1.00	15,000
40	477-225-B*	BT40B-SL 1/2 - 44.45	0.500	1.75	1.25	20,000
40	477-226-B*	BT40B-SL 1/2 - 65	0.500	2.55	1.25	15,000
40	477-227-B*	BT40B-SL 1/2 - 101.6	0.500	4.00	1.25	15,000
40	477-230-B*	BT40B-SL 5/8 - 44.45	0.625	1.75	1.50	20,000
40	477-231-B*	BT40B-SL 5/8 - 65	0.625	2.55	1.50	15,000
40	477-232-B*	BT40B-SL 5/8 - 101.6	0.625	4.00	1.50	15,000
40	477-235-B*	BT40B-SL 3/4 - 44.45	0.750	1.75	1.75	15,000
40	477-236-B*	BT40B-SL 3/4 - 65	0.750	2.55	1.75	12,000
40	477-237-B*	BT40B-SL 3/4 - 101.6	0.750	4.00	1.75	12,000
40	477-245-B*	BT40B-SL 1 - 44.45	1.000	1.75	2.25	15,000
40	477-250-B*	BT40B-SL 1-1/4 - 50.8	1.250	2.00	2.50	10,000
40	477-251-B*	BT40B-SL 1-1/4 - 85	1.250	3.35	2.50	10,000

NOTE: Achieving maximum rotation speed depends on the concentricity and symmetry of the cutting tool and the complete tool assembly.

* While stock is still available.

End Mill Holders - Metric Balanced - G6.3



BT Flange Tools

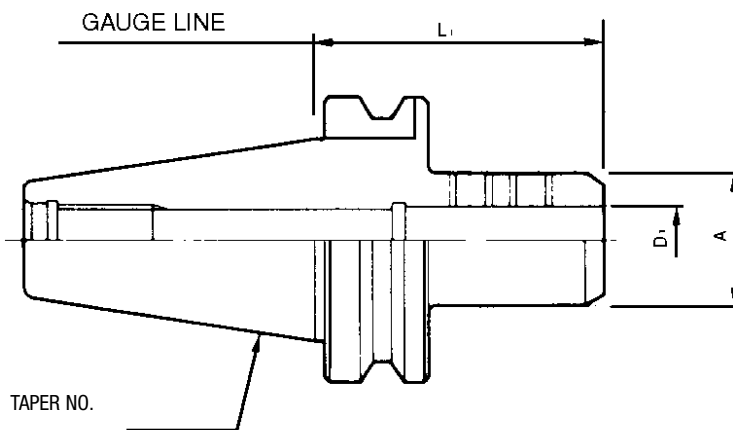

BT

BT40 15,000 RPM

Taper	Order No.	Device Type	D ₁ (mm)	L ₁ (mm)	A (mm)
40	477-106-M	BT40-SL 6-75	6	75	25
40	477-108-M	BT40-SL 8-75	8	75	28
40	477-112-M	BT40-SL 12-75	12	75	42
40	477-116-M	BT40-SL 16-75	16	75	48
40	477-120-M	BT40-SL 20-75	20	75	52
40	477-132-M	BT40-SL 32-90	32	90	64

End Mill Holders - Inch Balanced - G6.3

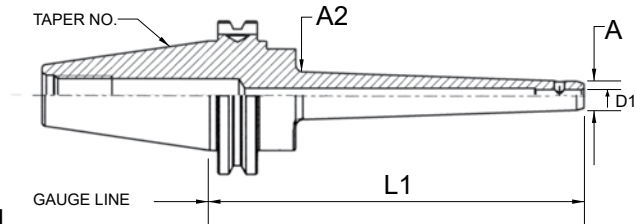

CT40 15,000 RPM

Taper	Order No.	Device Type	D ₁ (in)	L ₁ (in)	A (in)	A ₂ (in)
40	478-107	CT40-SL 3/16-6.00	0.1875	6.00	0.440	0.760 Tapered
40	478-112	CT40-SL 1/4-6.00	0.250	6.00	0.500	0.820 Tapered
40	478-122	CT40-SL 3/8-6.00	0.375	6.00	0.750	1.060 Tapered
40	478-127	CT40-SL 1/2-6.00	0.500	6.00	0.880	1.190 Tapered
40	478-132	CT40-SL 5/8-6.00	0.625	6.00	1.060	1.370 Tapered
40	478-137	CT40-SL 3/4-6.00	0.750	6.00	1.190	1.500 Tapered

CT Flange Tools

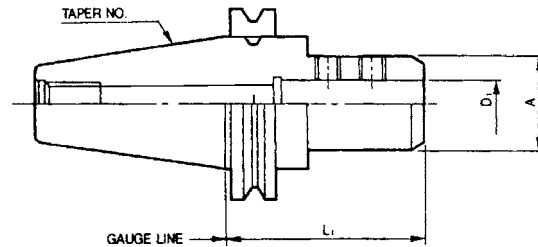

CT40 15,000 RPM

Taper	Order No.	Device Type	D1 (in)	L1 (in)	A (in)
40	478-100	CT40-SL 1/8-2.50	0.125	2.50	0.75
40	478-101	CT40-SL 1/8-4.00	0.125	4.00	0.75
40	478-105	CT40-SL 3/16-2.50	0.1875	2.50	0.75
40	478-106	CT40-SL 3/16-4.00	0.1875	4.00	0.75
40	478-110	CT40-SL 1/4-2.50	0.250	2.50	0.81
40	478-111	CT40-SL 1/4-4.00	0.250	4.00	0.81
40	478-115	CT40-SL 5/16-2.50	0.3125	2.50	1.00
40	478-116	CT40-SL 5/16-4.00	0.3125	4.00	1.00
40	478-120	CT40-SL 3/8-2.50	0.375	2.50	1.00
40	478-121	CT40-SL 3/8-4.00	0.375	4.00	1.00
40	478-123	CT40-SL 7/16-2.50	0.4375	2.50	1.15
40	478-125-S	CT40-SL 1/2-1.75	0.500	1.75	1.25
40	478-125	CT40-SL 1/2-2.50	0.500	2.50	1.25
40	478-126	CT40-SL 1/2-4.00	0.500	4.00	1.25
40	478-130-S	CT40-SL 5/8-1.75	0.625	1.75	1.75
40	478-130	CT40-SL 5/8-3.00	0.625	3.00	1.50
40	478-131	CT40-SL 5/8-5.00	0.625	5.00	1.50
40	478-135-S	CT40-SL 3/4-1.75	0.750	1.75	1.75
40	478-135	CT40-SL 3/4-3.50	0.750	3.50	1.75
40	478-136	CT40-SL 3/4-5.00	0.750	5.00	1.75
40	478-140	CT40-SL 7/8-3.50	0.875	3.50	2.00
40	478-141	CT40-SL 7/8-5.50	0.875	5.00	2.00
40	**478-145-S	CT40-SL 1-1.75	1.000	1.75	1.75
40	478-145	CT40-SL 1-4.00	1.000	4.00	2.25
40	478-146	CT40-SL 1-6.00	1.000	6.00	2.25
40	**478-150-S	CT40-SL 1-1/4-2.00	1.250	2.00	2.25
40	478-150	CT40-SL 1-1/4-4.00	1.250	4.00	2.50
40	478-151	CT40-SL 1-1/4-6.00	1.250	6.00	2.50
40	478-155	CT40-SL 1-1/2-4.75	1.500	4.75	2.75
45	*478-225	CT45-SL 1/2-2.50	0.500	2.50	1.25
45	*478-230	CT45-SL 5/8-3.00	0.625	3.00	1.50
45	*478-260	CT45-SL 2-5.50	2.000	5.50	3.75
45	*478-261	CT45-SL 2-7.50	2.000	7.50	3.75

**** These short stubby End Mill Holders may not work on all CNC machining centers with automatic tool changer.**

Please consult our order desk for details

* While stock is still available. Not balanced.

End Mill Holders - Inch Balanced - G6.3



CT

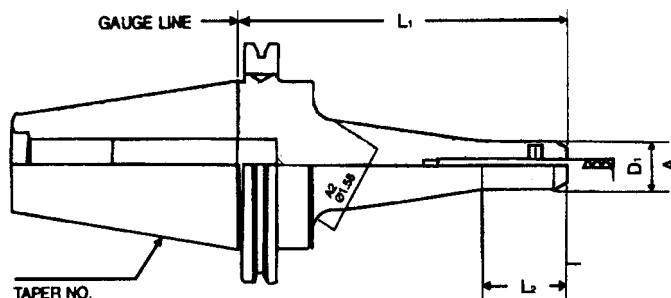

CT Flange Tools

Taper	Order No.	Device Type	D ₁ (in)	L ₁ (in)	L ₂ (in)	A (in)	A ₂ (in)
50	478-310*	CT50-SL 1/4-2.50	0.250	2.50	1.58	0.81	1.58 tapered
50	478-311	CT50-SL 1/4-4.50	0.250	4.50	1.58	0.81	1.58 tapered
50	478-312	CT50-SL 1/4-6.00	0.250	6.00	1.58	0.81	1.58 tapered
50	478-313*	CT50-SL 1/4-8.00	0.250	8.00	1.58	0.81	1.58 tapered

* While stock is still available. Not balanced.



CT

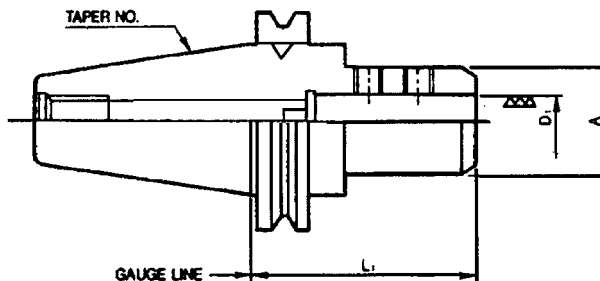

CT50 12,000 RPM

Taper	Order No.	Device Type	D ₁ (in)	L ₁ (in)	A (in)
50	478-320*	CT50-SL 3/8-2.50	0.375	2.50	1.00
50	478-321	CT50-SL 3/8-4.50	0.375	4.50	1.25
50	478-322	CT50-SL 3/8-6.00	0.375	6.00	1.50
50	478-323	CT50-SL 3/8-8.00	0.375	8.00	1.50
50	478-325	CT50-SL 1/2-2.63	0.500	2.63	1.25
50	478-326	CT50-SL 1/2-4.63	0.500	4.63	1.25
50	478-327	CT50-SL 1/2-6.00	0.500	6.00	1.50
50	478-328	CT50-SL 1/2-8.00	0.500	8.00	1.50
50	478-330	CT50-SL 5/8-3.75	0.625	3.75	1.50
50	478-331	CT50-SL 5/8-5.75	0.625	5.75	1.50
50	478-332	CT50-SL 5/8-8.00	0.625	8.00	1.65
50	478-335-S	CT50-SL 3/4-1.375	0.750	1.375	2.75
50	478-335	CT50-SL 3/4-3.75	0.750	3.75	1.75
50	478-336	CT50-SL 3/4-5.75	0.750	5.75	1.75
50	478-337	CT50-SL 3/4-8.00	0.750	8.00	1.75
50	478-341*	CT50-SL 7/8-5.75	0.875	5.75	2.00
50	478-342*	CT50-SL 7/8-8.00	0.875	8.00	2.00
50	478-345-S	CT50-SL 1-1.375	1.000	1.375	2.75
50	478-345	CT50-SL 1-4.00	1.000	4.00	2.25
50	478-346	CT50-SL 1-6.00	1.000	6.00	2.25
50	478-347	CT50-SL 1-8.00	1.000	8.00	2.25
50	478-350-S	CT50-SL 1-1/4-1.375	1.250	1.375	2.75
50	478-350	CT50-SL 1-1/4-4.00	1.250	4.00	2.50
50	478-351	CT50-SL 1-1/4-6.00	1.250	6.00	2.50
50	478-352	CT50-SL 1-1/4-8.00	1.250	8.00	2.50
50	478-355	CT50-SL 1-1/2-4.00	1.500	4.00	2.75
50	478-356**	CT50-SL 1-1/2-6.00	1.500	6.00	2.75
50	478-357	CT50-SL 1-1/2-8.00	1.500	8.00	2.75
50	478-360	CT50-SL 2-6.00	2.00	6.00	3.75
50	478-361	CT50-SL 2-8.00	2.00	8.00	3.75

* While stock is still available. ** Not Balanced.

End Mill Holders - Inch High Balanced - G2.5



CT Flange Tools

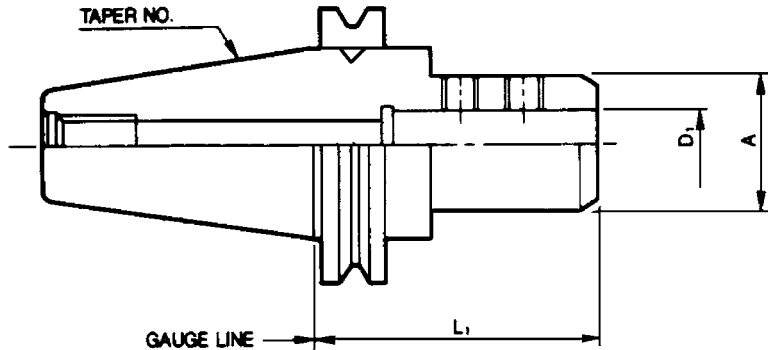

CT

Taper	Order No.	Device Type	D ₁ (in)	L ₁ (in)	A (in)	Max RPM
40	478-200-B	CT40B-SL 1/8" - 2.50	0.125	2.50	0.75	20,000
40	478-201-B	CT40B-SL 1/8 - 4.00	0.125	4.00	0.75	15,000
40	478-205-B	CT40B-SL 3/16 - 2.50	0.1875	2.50	0.75	20,000
40	478-206-B	CT40B-SL 3/16 - 4.00	0.1875	4.00	0.75	15,000
40	478-210-B	CT40B-SL 1/4 - 2.50	0.250	2.50	0.81	20,000
40	478-211-B	CT40B-SL 1/4 - 4.00	0.250	4.00	0.81	15,000
40	478-215-B	CT40B-SL 5/16 - 2.50	0.3125	2.50	1.00	20,000
40	478-216-B	CT40B-SL 5/16 - 4.00	0.3125	4.00	1.00	15,000
40	478-220-B	CT40B-SL 3/8 - 2.50	0.375	2.50	1.00	20,000
40	478-221-B	CT40B-SL 3/8 - 4.00	0.375	4.00	1.00	15,000
40	478-225-B	CT40B-SL 1/2 - 1.75	0.500	1.75	1.75	20,000
40	478-226-B	CT40B-SL 1/2 - 2.50	0.500	2.50	1.25	15,000
40	478-227-B	CT40B-SL 1/2 - 4.00	0.500	4.00	1.25	15,000
40	478-230-B	CT40B-SL 5/8 - 1.75	0.625	1.75	1.75	20,000
40	478-231-B	CT40B-SL 5/8 - 3.00	0.625	3.00	1.50	15,000
40	478-232-B	CT40B-SL 5/8 - 5.00	0.625	5.00	1.50	15,000
40	478-235-B	CT40B-SL 3/4 - 1.75	0.750	1.75	1.75	15,000
40	478-236-B	CT40B-SL 3/4 - 3.50	0.750	3.50	1.75	12,000
40	478-237-B	CT40B-SL 3/4 - 5.00	0.750	5.00	1.75	12,000
40	478-240-B	CT40B-SL 7/8 - 3.50	0.875	3.50	2.00	12,000
40	478-241-B	CT40B-SL 7/8 - 5.50	0.875	5.50	2.00	12,000
40	478-245-B	CT40B-SL 1 - 1.75	1.000	1.75	1.75	15,000
40	478-246-B	CT40B-SL 1 - 4.00	1.000	4.00	2.25	12,000
40	478-247-B	CT40B-SL 1 - 6.00	1.000	6.00	2.25	12,000
40	478-250-B	CT40B-SL 1-1/4 - 2.00	1.250	2.00	2.25	10,000
40	478-251-B	CT40B-SL 1-1/4 - 4.00	1.250	4.00	2.50	8,000
40	478-252-B	CT40B-SL 1-1/4 - 6.00	1.250	6.00	2.50	8,000

NOTE: Achieving maximum rotation speed depends on the concentricity and symmetry of the cutting tool and the complete tool assembly.

End Mill Holders - Metric Balanced G6.3



CT Flange Tools

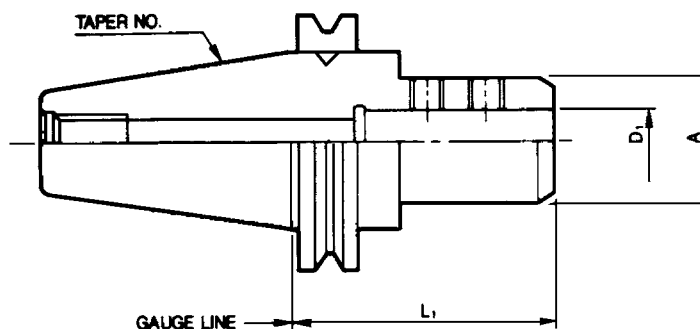

CT

CT40 15,000 RPM
CT50 12,000 RPM

Taper	Order No.	Device Type	D ₁ (mm)	L ₁ (in)	A (mm)
40	478-108-M	CT40-SL 8-2.50	8	2.50	28
40	478-109-M	CT40-SL 8-4.00	8	4.00	28
40	478-110-M	CT40-SL 10-2.50	10	2.50	35
40	478-111-M	CT40-SL 10-4.00	10	4.00	35
40	478-114-M	CT40-SL 14-3.00	14	3.00	42
40	478-116-M	CT40-SL 16-3.00	16	3.00	48
40	478-117-M	CT40-SL 16-5.00	16	5.00	48
40	478-118-M	CT40-SL 18-3.00	18	3.00	50
40	478-120-M	CT40-SL 20-3.00	20	3.00	52
40	478-125-M	CT40-SL 25-4.00	25	4.00	64
40	478-132-M	CT40-SL 32-4.00	32	4.00	64
50	478-307-M	CT50-SL 6-4.50	6	4.50	25
50	478-310-M	CT50-SL 10-2.50	10	2.50	35
50	478-313-M	CT50-SL 12-4.50	12	4.50	42
50	478-316-M	CT50-SL 16-3.75	16	3.75	48
50	478-318-M	CT50-SL 18-3.75	18	3.75	50
50	478-320-M	CT50-SL 20-3.75	20	3.75	52
50	478-325-M	CT50-SL 25-4.00	25	4.00	64
50	478-332-M	CT50-SL 32-4.00	32	4.00	72
50	478-340-M	CT50-SL 40-4.00	40	4.00	80
50	478-350-M**	CT50-SL 50-6.00	50	6.00	100

** Not Balanced.

End Mill Holders

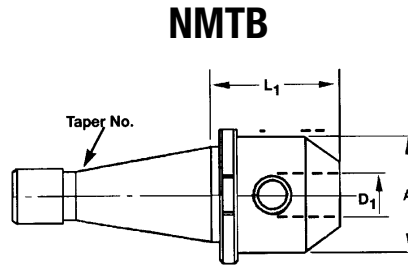

R8

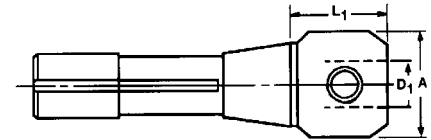

R8 & NMTB-QC Flange Tools

NMTB Tool Holders are
qualified for use with
Erickson QC spindles

**CLEAROUT
SALE
NMTB30QC
NMTB50QC
R8**

Taper	Order No.	Device Type	D ₁ (in)	L ₁ (in)	A (in)
30	678-000*	NMTB30QC-SL 1/8-1.75	0.125	1.75	0.75
30	678-005*	NMTB30QC-SL 3/16-1.75	0.1875	1.75	0.75
30	678-010*	NMTB30QC-SL 1/4-1.75	0.250	1.75	0.81
30	678-020*	NMTB30QC-SL 3/8-1.75	0.375	1.75	1.00
30	678-025*	NMTB30QC-SL 1/2-1.75	0.500	1.75	1.25
30	678-030*	NMTB30QC-SL 5/8-1.75	0.625	1.75	1.50
30	678-040*	NMTB30QC-SL 7/8-2.25	0.875	2.25	2.00
30	678-045*	NMTB30QC-SL 1-2.6875	1.000	2.6875	2.25
40	678-200	NMTB40QC-SL 1/8-2.3125	0.125	2.3125	0.75
40	678-205	NMTB40QC-SL 3/16-2.3125	0.1875	2.3125	0.75
40	678-210	NMTB40QC-SL 1/4-2.3125	0.250	2.3125	0.81
40	678-215	NMTB40QC-SL 5/16-2.3125	0.3125	2.3125	1.00
40	678-220	NMTB40QC-SL 3/8-2.3125	0.375	2.3125	1.00
40	678-225	NMTB40QC-SL 1/2-2.3125	0.500	2.3125	1.25
40	678-230	NMTB40QC-SL 5/8-2.3125	0.625	2.3125	1.50
40	678-235	NMTB40QC-SL 3/4-2.3125	0.750	2.3125	1.75
40	678-240	NMTB40QC-SL 7/8-2.9375	0.875	2.9375	2.00
40	678-245	NMTB40QC-SL 1-3.375	1.000	3.375	2.25
40	678-250	NMTB40QC-SL 1-1/4-3.6875	1.250	3.6875	2.50
40	678-255	NMTB40QC-SL 1-1/2-3.9375	1.500	3.9375	2.75
50	678-420*	NMTB50QC-SL 3/8-2.75	0.375	2.75	1.00
50	678-425*	NMTB50QC-SL 1/2-2.75	0.500	2.75	1.25
50	678-430*	NMTB50QC-SL 5/8-2.75	0.625	2.75	1.50
50	678-435*	NMTB50QC-SL 3/4-2.875	0.750	2.875	1.75
50	678-455*	NMTB50QC-SL 1-1/2-4.00	1.500	4.00	2.75
50	678-460*	NMTB50QC-SL 2-4.6875	2.000	4.6875	3.75
R8	678-800*	R8-SL 1/8	0.125	1.3125	0.75
R8	678-805*	R8-SL 3/16	0.1875	1.3125	0.75
R8	678-810*	R8-SL 1/4	0.250	1.3125	0.8125
R8	678-820*	R8-SL 3/8	0.375	1.3125	1.00
R8	678-825*	R8-SL 1/2	0.500	1.3125	1.375
R8	678-830*	R8-SL 5/8	0.625	1.500	1.625
R8	678-835*	R8-SL 3/4	0.750	2.375	1.875
R8	678-850*	R8-SL 1-1/4	1.250	3.250	2.50
R8	678-855*	R8-SL 1-1/2	1.500	3.750	3.00

* While stock is still available. ** Not Balanced.

End Mill Holders - Inch

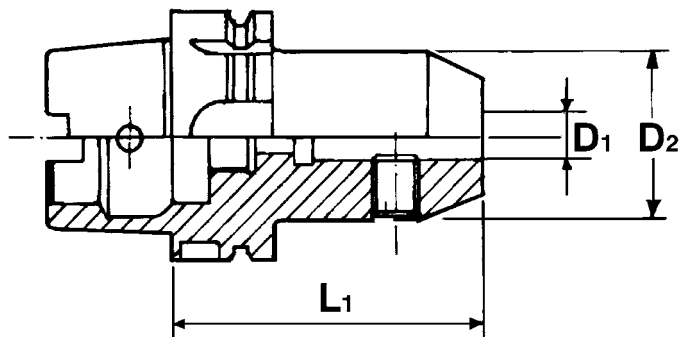

HSK A

Taper	Order No.	Device Type	D1 (in)	L1 (in)	D2 (in)	Max RPM
63	578-505A	HSK63A-SL 3/16"-3.00	0.1875	3.00	0.75	20,000
63	578-506A	HSK63A-SL 3/16"-5.00	0.1875	5.00	0.75	15,000
63	578-510A	HSK63A-SL 1/4"-3.00	0.250	3.00	0.81	20,000
63	578-511A	HSK63A-SL 1/4"-5.00	0.250	5.00	0.81	15,000
63	578-515A	HSK63A-SL 5/16"-3.00	0.3125	3.00	1.00	20,000
63	578-516A	HSK63A-SL 5/16"-5.00	0.3125	5.00	1.00	15,000
63	578-520A	HSK63A-SL 3/8"-3.00	0.375	3.00	1.00	20,000
63	578-521A	HSK63A-SL 3/8"-5.00	0.375	5.00	1.00	15,000
63	578-525A	HSK63A-SL 1/2"-4.00	0.500	4.00	1.25	15,000
63	578-526A	HSK63A-SL 1/2"-5.00	0.500	5.00	1.25	15,000
63	578-530A	HSK63A-SL 5/8"-4.00	0.625	4.00	1.50	15,000
63	578-531A	HSK63A-SL 5/8"-5.00	0.625	5.00	1.50	15,000
63	578-535A	HSK63A-SL 3/4"-4.50	0.750	4.50	1.75	12,000
63	578-536A	HSK63A-SL 3/4"-6.00	0.750	6.00	1.75	12,000
63	578-545A	HSK63A-SL 1"-4.50	1.000	4.50	2.25	12,000
63	578-546A	HSK63A-SL 1"-6.00	1.000	6.00	2.25	12,000
63	578-550A	HSK63A-SL 1-1/4"-4.50	1.250	4.50	2.25	8,000
63	578-551A	HSK63A-SL 1-1/4"-6.00	1.250	6.00	2.25	8,000

NOTE: Achieving maximum rotation speed depends on the concentricity and symmetry of the cutting tool and the complete tool assembly.

Set Screws for End Mill Holders

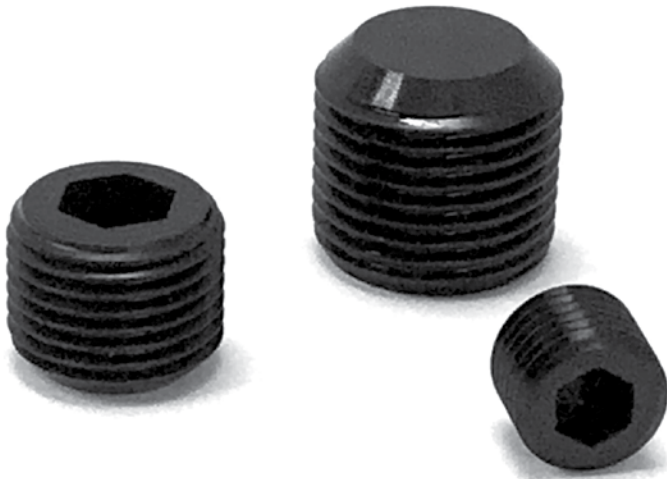

End Mill Holder Size	Order No.	Set Screw Size
1/8"	30116-501	No. 8 - 32UNC x 1/4"
3/16"	30116-502	No. 10 - 32UNF x 1/4"
1/4"	30116-503	1/4" - 28UNF x 1/4"
5/16"	30116-503	1/4" - 28UNF x 1/4"
3/8"	30116-504	3/8" - 24UNF x 8MM
1/2"	30116-505	7/16" - 20UNF x 3/8"
1/2" (478-125-S)	30116-941	3/8" - 24UNF x 8MM
5/8"	30116-506	9/16" - 18UNF x 12MM
5/8" (478-130-S)	30116-961	9/16" - 18UNF x 12MM
3/4"	30116-507	5/8" - 18UNF x 1/2"
3/4" (478-135-S)	30116-972	5/8" - 18UNF x 7/16"
7/8"	30116-507	5/8" - 18UNF x 1/2"
1"	30116-508	3/4" - 16UNF x 11/16"
1" (478-145-S)	30116-982	3/4" - 16UNF x 3/8"
1-1/4"	30116-508	3/4" - 16UNF x 11/16"
1-1/4" (478-150-S)	30116-982	3/4" - 16UNF x 3/8"
1-1/2"	30116-508	3/4" - 16UNF x 11/16"
2"	30116-509	1" - 14UNF x 7/8"

End Mill Holder Size	Order No.	Set Screw Size
6MM	30116-061	M6 x 1P
8MM	30116-081	M8 x 1.25P
10MM	30116-101	M10 x 1.5P
12MM	30116-121	M12 x 1.75P
14MM	30116-121	M12 x 1.75P
16MM	30116-141	M14 x 2.0P
18MM	30116-141	M14 x 2.0P
20MM	30116-161	M16 x 2.0P
25MM	30116-181	M18 x 2.0P
32MM	30116-201	M20 x 2.0P
40MM	30116-201	M20 x 2.0P
42MM	30116-201	M20 x 2.0P