

ECX (ER) Superflex & No. 25 (SYOZ/RD025) Precision Collet Chucks for CNC Routers Individually Balanced G2.5

3um - 0.0001" Runout Taper To Taper
Tapers are ground AT3 or better for Optimal T.I.R

For use with ER/ECX style
collet chucks. See pages
2-7 to 2-11 for collet
information.

For collet nuts and
wrenches see pages 1-21
to 1-22 and 2-16 to 2-18.

For use with 462E/SYOZ25
style collet chucks. See
pages 2-31 for collet
information.

ER/ECX

SYOZ/RDO

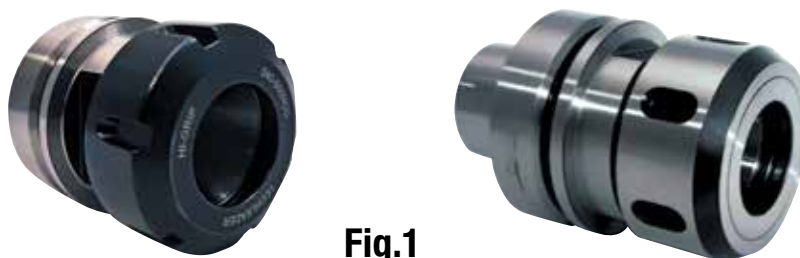
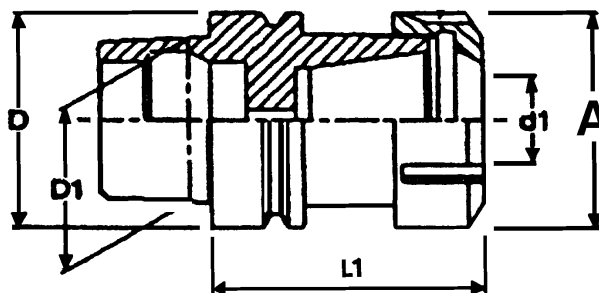

Fig.1



HSK-F

NUT STYLES

- C = CASTELLATION
- H = HEXAGON
- S = SPANNER
- M = MINI CASTELLATION

THEORETICAL MAX

Tightening Torque for ER/ECX nuts

ECX/ER11M	25Nm/18FT/lbs
ECX/ER16M	35Nm/25FT/lbs
ECX/ER25	140Nm/103FT/lbs
ECX/ER32	180Nm/132FT/lbs
ECX/ER40	230Nm/169FT/lbs
RDK25/462E	180Nm/132FT/lbs

Taper	Order No.	Device Type	Collet	D ₁ (in) Collet Range	L ₁ (mm)	A (in)	Max RPM	Nut Style
NEW	63F 584-516MF	HSK63F-ECX/ER16M-70 mm	ECX/ER16	0.020 - 0.394	70	0.866	25,000	M
NEW	63F 584-517MF	HSK63F-ECX/ER16M-4.00"	ECX/ER16	0.020 - 0.394	4.00"	0.866	25,000	M
NEW	63F 584-525F	HSK63F-ECX/ER25-70 mm	ECX/ER25	0.020 - 0.629	70	1.654	25,000	C
	63F 584-532F	HSK63F-ECX/ER32-73 mm	ECX/ER32	0.059 - 0.787	73	1.97	25,000	C
	63F 584-540F	HSK63F-ECX/ER40-76.5 mm	ECX/ER40	0.112 - 1.024	76.5	2.48	25,000	C
	63F 584-5025F	HSK63F-NO.25-75 mm	462E/SYOZ25	0.125 - 1.000	75	2.36	25,000	S

NOTE: Achieving maximum rotation speed depends on the concentricity and symmetry of the cutting tool and the complete tool assembly.