



										H320-4	H320TC-4			
H320-4														
H320TC-4	TiCN													
$\varnothing d_1$ M	P mm	l_1 mm	l_2 mm	l_3 mm	d_2 mm	a mm				ID	ID			
2	0.40	45	8.0		2.8	2.1	2	1.60		101206				
2.2	0.45	45	9.0		2.8	2.1	2	1.75		111801				
2.5	0.45	50	10.0		2.8	2.1	3	2.05		101207				
3	0.50	56	12.0	18	3.5	2.7	3	2.50		101209	111836			
3.5	0.60	56	13.0	20	4.0	3.0	3	2.90		101210				
4	0.70	63	14.0	21	4.5	3.4	3	3.30		101211	111502			
4.5	0.75	70	15.0	25	6.0	4.9	3	3.75		101212				
5	0.80	70	15.0	25	6.0	4.9	3	4.20		101213	111458			
6	1.00	80	17.0	30	6.0	4.9	3	5.00		101215	111456			
8	1.25	90	20.0	35	8.0	6.2	3	6.80		101218	111453			
10	1.50	100	22.0	39	10.0	8.0	3	8.50		101205	110911			

									H420-4	H420TC-4						
H420-4																
H420TC-4																
Ø d ₁ M	P mm	l ₁ mm	l ₂ mm	d ₂ mm	a mm				ID	ID						
12	1.75	110	24.0	9.0	7.0	4	10.20		101275	110912						
14	2.00	110	28.0	11.0	9.0	4	12.00		101277							
16	2.00	110	30.0	12.0	9.0	4	14.00		101279	111612						
18	2.50	125	33.0	14.0	11.0	4	15.50		101281							
20	2.50	140	36.0	16.0	12.0	4	17.50		101284							
24	3.00	160	39.0	18.0	14.5	4	21.00		101286							
27	3.00	160	42.0	20.0	16.0	4	24.00		101287							
30	3.50	180	45.0	22.0	18.0	4	26.50		101288							
36	4.00	200	51.0	28.0	22.0	4	32.00		101289							



									H350-3	H350-3	H350TC-3	
H350-3 												
H350TC-3 												
$\varnothing d_1$ M	P mm	l_1 mm	l_2 mm	l_3 mm	d_2 mm	a mm			ID	ID ^{6H} + mm	ID	
2	0.40	45	7.0		2.8	2.1	2	1.60	101238			
2.5	0.45	50	9.0		2.8	2.1	3	2.05	101239		144957	
3	0.50	56	5.5	18	3.5	2.7	3	2.50	101242	101241	0.020	111835
3.5	0.60	56	6.5	20	4.0	3.0	3	2.90	101243			
4	0.70	63	7.5	21	4.5	3.4	3	3.30	101245	101244	0.022	111607
4.5	0.75	70	9.0	25	6.0	4.9	3	3.75	101246			
5	0.80	70	9.0	25	6.0	4.9	3	4.20	101248	101247	0.024	111610
6	1.00	80	11.0	30	6.0	4.9	3	5.00	101251	101250	0.026	111500
8	1.25	90	12.5	35	8.0	6.2	3	6.80	101255	101254	0.028	110963
10	1.50	100	14.0	39	10.0	8.0	3	8.50	101237	101236	0.032	111454

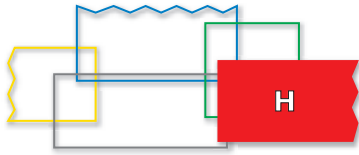

H450-3



H450TC-3



H450-3

H450-3

H450TC-3

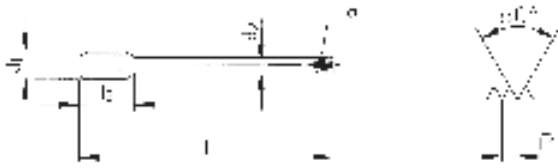

Ø d ₁ M	P mm	l ₁ mm	l ₂ mm	d ₂ mm	a mm		
12	1.75	110	14.0	9.0	7.0	4	10.20
14	2.00	110	14.0	11.0	9.0	4	12.00
16	2.00	110	18.0	12.0	9.0	4	14.00
18	2.50	125	21.0	14.0	11.0	4	15.50
20	2.50	140	24.0	16.0	12.0	4	17.50
22	2.50	140	24.0	18.0	14.5	4	19.50
24	3.00	160	27.0	18.0	14.5	4	21.00
27	3.00	160	27.0	20.0	16.0	4	24.00
30	3.50	180	30.0	22.0	18.0	4	26.50
36	4.00	200	36.0	28.0	22.0	4	32.00
42	4.50	200	40.0	32.0	24.0	4	37.50

ID

ID

6H
+ mm

ID

101305

101304

0.034

111501

101307

101309

101311

101313

101315

101318

101320

101323

101324

101325

111605

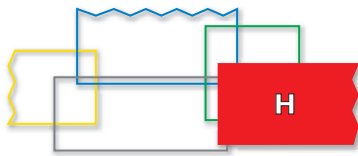

										H320-4	H420-4		
H320-4													
H420-4													
$\varnothing d_1$ MF	P mm	l_1 mm	l_2 mm	l_3 mm	d_2 mm	a mm				ID	ID		
6	0.75	80	17.0	30	6.0	4.9	3	5.25		101214			
8	0.75	90	20.0	35	8.0	6.2	3	7.25		101216			
8	1.00	90	20.0	35	8.0	6.2	3	7.00		101217			
10	1.00	100	22.0	39	10.0	8.0	3	9.00		101204			
12	1.25	100	24.0		9.0	7.0	4	10.80			101273		
12	1.50	100	24.0		9.0	7.0	4	10.50			101274		
14	1.50	100	24.0		11.0	9.0	4	12.50			101276		
16	1.50	100	26.0		12.0	9.0	4	14.50			101278		
20	1.50	125	28.0		16.0	12.0	4	18.50			101282		
24	2.00	140	34.0		18.0	14.5	4	22.00			101285		

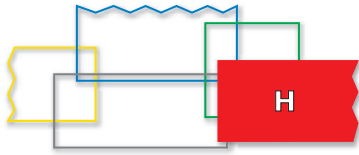

H350-3

H450-3

H350-3



H450-3



ISO 2
6H

ISO 2
6H

Ø d ₁ MF	P mm	l ₁ mm	l ₂ mm	l ₃ mm	d ₂ mm	a mm		
6	0.75	80	11.0	30	6.0	4.9	3	5.25
8	0.75	90	12.5	35	8.0	6.2	3	7.25
8	1.00	90	12.5	35	8.0	6.2	3	7.00
10	1.00	100	14.0	39	10.0	8.0	3	9.00
12	1.00	100	14.0		9.0	7.0	4	11.00
12	1.50	100	14.0		9.0	7.0	4	10.50
14	1.50	100	14.0		11.0	9.0	4	12.50
16	1.50	100	14.0		12.0	9.0	4	14.50
18	1.50	110	18.0		14.0	11.0	4	16.50
20	1.50	125	20.0		16.0	12.0	4	18.50
22	1.50	125	20.0		18.0	14.5	4	20.50
24	1.50	140	22.0		18.0	14.5	4	22.50
24	2.00	140	22.0		18.0	14.5	4	22.00
27	2.00	140	22.0		20.0	16.0	4	25.00
30	1.50	150	24.0		22.0	18.0	4	28.50
30	2.00	150	24.0		22.0	18.0	4	28.00

ID

ID

101249

101252

101253

101235

101302

101303

101306

101308

101310

101312

101314

101316

101317

101319

101321

101322

UNC ANSI B1.1

PM

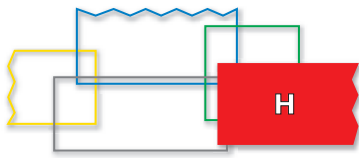

										H320-4	H420-4	H350-3	H450-3						
<div style="display: flex; flex-direction: column;"> <div style="margin-bottom: 10px;"> H320-4 15 16 62 82 </div> <div style="margin-bottom: 10px;"> H420-4 15 16 62 82 </div> <div style="margin-bottom: 10px;"> H350-3 15 16 62 82 </div> <div> H450-3 15 16 62 82 </div> </div>																			
										2B	2B	2B	2B						
\varnothing " d ₁ UNC	P TPI	d ₁ mm	l ₁ mm	l ₂ mm	l ₃ mm	d ₂ mm	a mm			ID	ID								
2	56	2.18	45	8.0		2.8	2.1	2	1.75	101221									
4	40	2.84	56	10.0	18	3.5	2.7	3	2.25	101223									
6	32	3.50	56	13.0	20	4.0	3.0	3	2.75	101225									
8	32	4.16	63	14.0	21	4.5	3.4	3	3.40	101226									
10	24	4.82	70	15.0	25	6.0	4.9	3	3.80	101220									
1/4	20	6.35	80	17.0	30	7.0	5.5	3	5.10	101219									
5/16	18	7.93	90	20.0	35	8.0	6.2	3	6.50	101224									
3/8	16	9.52	100	22.0	39	10.0	8.0	3	8.00	101222									
1/2	13	12.70	110	24.0		9.0	7.0	4	10.80		101290								
\varnothing " d ₁ UNC	P TPI	d ₁ mm	l ₁ mm	l ₂ mm	l ₃ mm	d ₂ mm	a mm			ID	ID								
2	56	2.18	45	8.0		2.8	2.1	2	1.75		101258								
4	40	2.84	56	5.5	18	3.5	2.7	3	2.25		101260								
6	32	3.50	56	6.5	20	4.0	3.0	3	2.75		101262								
8	32	4.16	63	7.5	21	4.5	3.4	3	3.40		101263								
10	24	4.82	70	9.0	25	6.0	4.9	3	3.80		101257								
1/4	20	6.35	80	11.0	30	7.0	5.5	3	5.10		101256								
5/16	18	7.93	90	12.5	35	8.0	6.2	3	6.50		101261								
3/8	16	9.52	100	14.0	39	10.0	8.0	3	8.00		101259								
7/16	14	11.11	100	14.0		8.0	6.2	3	9.30			101330							
1/2	13	12.70	110	14.0		9.0	7.0	4	10.80			101326							
5/8	11	15.87	110	18.0		12.0	9.0	4	13.60			101329							
3/4	10	19.05	125	21.0		14.0	11.0	4	16.60			101328							
1	8	25.40	160	27.0		18.0	14.5	4	22.30			101327							

UNC

UNF ANSI B1.1

PM

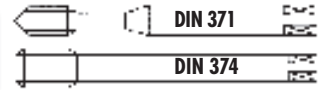

										H320-4	H420-4		
H320-4													
H420-4													
$\varnothing'' d_1$ UNF	P TPI	d_1 mm	l_1 mm	l_2 mm	l_3 mm	d_2 mm	α mm			ID	ID		
10	32	4.82	70	15.0	25	6.0	4.9	3	4.05	101228			
1/4	28	6.35	80	17.0	30	7.0	5.5	3	5.50	101227			
5/16	24	7.93	90	20.0	35	8.0	6.2	3	6.90	105139			
3/8	24	9.52	100	22.0	39	10.0	8.0	3	8.50	101229			
1/2	20	12.70	100	24.0		9.0	7.0	4	11.40		101291		
3/4	16	19.05	125	33.0		14.0	11.0	4	17.50		* 101292		

UNF ANSI B1.1

PM

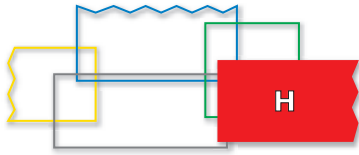

H350-3



H450-3

H350-3

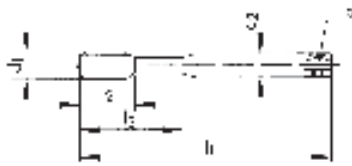

H450-3



$\varnothing'' d_1$ UNF	P TPI	d_1 mm	l_1 mm	l_2 mm	l_3 mm	d_2 mm	a mm		
10	32	4.82	70	9.0	25	6.0	4.9	3	4.05
1/4	28	6.35	80	11.0	30	7.0	5.5	3	5.50
5/16	24	7.93	90	12.5	35	8.0	6.2	3	6.90
3/8	24	9.52	100	14.0	39	10.0	8.0	3	8.50
7/16	20	11.11	100	14.0		8.0	6.2	3	9.80
1/2	20	12.70	100	14.0		9.0	7.0	4	11.40
5/8	18	15.87	100	14.0		12.0	9.0	4	14.50
3/4	16	19.05	125	18.0		14.0	11.0	4	17.50

ID

ID

101265

101264

101267

101266

101334

101331

101333

101332

UNF