



**1 • High Performance and High Accuracy** It has the same structure as CGH power chuck, and has excellent performance and quality. Mounting face and changable parts are compatible each other. **2 • Spindle Direct-Mounting Type** International standard A-type spindle specification is applied to Mounting face, so that it can be directly attached to short taper spindle. **3 • Shortening of changing time** Chuck-changing-time can be minimized as run-out accuracy is kept upon attachment. **4 • Convenient Attachment Option** Because adapters suitable to various spindle specifications can be manufactured and attached, the scope of application is extensive.

**1 •性能好, 精度高:** 此卡盘与CGH型卡盘结构相同, 因此确保其优越的性能和质量, 且附件和连接部件具有兼容性. **2 •直接安装型:** 可直接安装在符合国际标准A型主轴的短锥安装面上. **3 •换装方便:** 若更换附件可在最短的时间内, 达到其运行的精度要求. **4 •便于安装选择:** 可通过转接法兰与各种不同规格的主轴连接, 扩大了其使用范围.

**1 •高性能, 高精度 2 •스핀들 직장형 3 •取替え時間短縮 4 •便利な取付けオプション**

**1 • 고성능 · 고정도 2 • 스펀들 직장형 3 • 교체시간 단축 4 • 부착옵션 용이**

### Outward Drawing/外型图/外形图/외형도

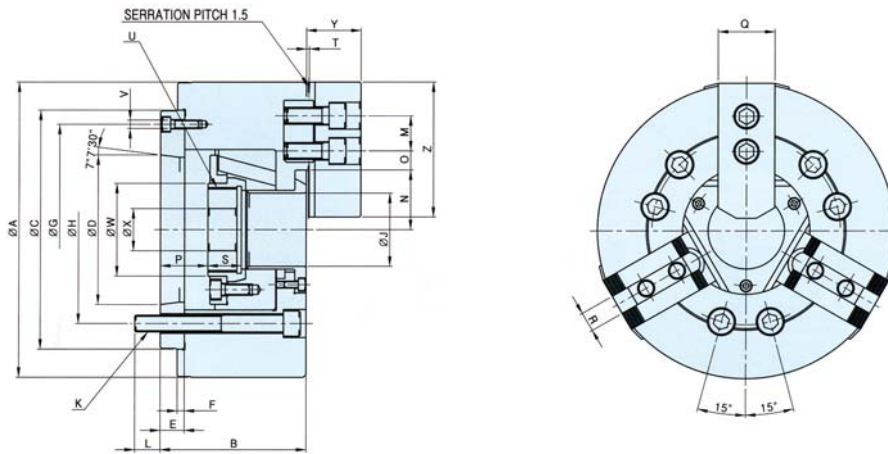

### Dimension/尺寸/寸法表/치수표

| Model 형식 | A   | B   | C   | D     | E  | F  | G | H   | J     | K   | L     | M  | Nmax | Nmin  | Omax  | Omin  | Pmax  | Pmin | Q   | R  | S  | T    | U max | V       | W     | X   | Y  | Z    |     |
|----------|-----|-----|-----|-------|----|----|---|-----|-------|-----|-------|----|------|-------|-------|-------|-------|------|-----|----|----|------|-------|---------|-------|-----|----|------|-----|
| CGHA-06  | 170 | 91  | 140 | 82.5  | 63 | 15 | 5 | 116 | 104.8 | 53  | 6-M10 | 16 | 20   | 37    | 34.24 | 21    | 8     | 27   | 14  | 31 | 12 | 19   | 2     | M8X2.0  | 3-M6  | 66  | 20 | 33.5 | 72  |
| CGHA-08  | 210 | 111 | 170 | 106.3 | 75 | 26 | 5 | 150 | 133.4 | 66  | 6-M12 | 21 | 25   | 46.2  | 42.4  | 23.25 | 10.25 | 33   | 15  | 39 | 14 | 20.5 | 2     | M7X2.0  | 3-M6  | 88  | 30 | 39   | 95  |
| CGHA-10  | 254 | 113 | 220 | 139.7 | 19 | 18 | 5 | 190 | 171.4 | 82  | 6-M16 | 24 | 30   | 56.27 | 52.2  | 31    | 12    | 27.5 | 7.5 | 44 | 16 | 27   | 2     | M9X2.0  | 3-M8  | 98  | 30 | 45   | 110 |
| CGHA-12  | 315 | 126 | 300 | 196.8 | 69 | 34 | 6 | 260 | 235   | 108 | 6-M20 | 28 | 30   | 68.64 | 63.54 | 45.75 | 13.75 | 30   | 6   | 49 | 21 | 30   | 2.5   | M11X2.0 | 3-M10 | 124 | 66 | 51.3 | 111 |

### Specifications/规格/仕様表/사양표

| Spec. 사양<br>Model 형식 | Order NO.<br>오더번호 | Spindle nose NO.<br>주축 규격 | Thru-hole (Diameter)<br>관통경(직경)mm | Jaw stroke (Diameter)<br>조스트로크(직경)mm | Plunger stroke<br>플런저 스트로크 mm | Gripping Dia. (Extend gripping)<br>파악경(외경파악)mm |        | Max. permissible input force/허용 실린더력 KN(kgf) |
|----------------------|-------------------|---------------------------|-----------------------------------|--------------------------------------|-------------------------------|--|--------|--|
|                      |                   |                           |                                   |                                      |                               | Max 최대   | Min 최소 |  |
| CGHA-06              | 1GHA06            | A2-5                      | 53                                | 5.5                                  | 13                            | 169  | 13     | 25(2550)                                     |
| CGHA-08              | 1GHA08            | A2-6                      | 66                                | 7.6                                  | 18                            | 210  | 11     | 38(3900)                                     |
| CGHA-10              | 1GHA10            | A2-8                      | 82                                | 8.5                                  | 20                            | 254  | 31     | 50(5100)                                     |
| CGHA-12              | 1GHA12            | A2-11                     | 103                               | 10.2                                 | 24                            | 315  | 45     | 55(5610)                                     |

| Spec. 사양<br>Model 형식 | Max. static gripping force<br>최대 정적파악력 KN(kgf) | Max. permissible speed<br>최고 사용회전수 r.p.m.(min <sup>-1</sup> ) | Weight (With standard soft jaws)<br>중량(표준 소프트 죠 포함) kg | GD <sup>2</sup><br>Moment of inertia N·m <sup>2</sup> (kgf·m <sup>2</sup> ) | Matching cylinder<br>적용실린더 | Matching hard jaw<br>적용하드 죠 | Matching soft jaw<br>적용소프트 죠 |
|----------------------|--|---|--|---|----------------------------|-----------------------------|------------------------------|
| CGHA-06              | 63(6426)                                       | 6000  | 13.7   | 245(0.25)   | YSGH-06                    | HJ-06T1                     | SJ-06T1                      |
| CGHA-08              | 94(9597)                                       | 5000  | 23.6   | 690(0.71)   | YSGH-08                    | HJ-08T1                     | SJ-08T1                      |
| CGHA-10              | 120(12240)                                     | 4500  | 40   | 1265(1.29)  | YGH-10                     | HJ-10T1                     | SJ-10T1                      |
| CGHA-12              | 145(15000)                                     | 3000  | 55   | 295   | YSH-10                     | HJ-12A1                     | SJ-12A1                      |